



Wireless Switch Module For up to 6-way switching

Rating:

Controller: 220 - 240VAC, 50 Hz

Switch: 3V CR2032

ON/OFF model:

500W Incandescent/
LED/CFL/Fluorescent/
Halogen

Dimmer model:

150W Incandescent/
Dimmable LED/ Dimmable
Halogen



INSTALLATION INSTRUCTIONS

INTRODUCTION

VOLT's Wireless Switch Module is designed to streamline the installation of light switches in an existing or new home. The kit features wireless modules that adapt to conventional switch mechanisms eliminating the need to run extra wiring.

FEATURES

Switch Module

- Easy to install
- No wiring to switch needed
- Long battery life
- Up to 15m range indoors (extendible using repeater)

Controller

- Simple installation in wall or ceiling cavity
- Receives from multiple switches
- Flicker free trailing edge dimming (dimmer version)

STEP 1 WARNING: TO AVOID FIRE SHOCK OR DEATH; TURN OFF POWER at circuit breaker.

Test that power is off before wiring!

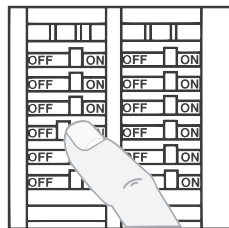

STEP 2 Identify your wiring application (most common):

Ceiling install; Ensure you have a permanent feed to the lighting - install the receiver before the first luminaire in a lighting string. If the wireless switch is to replace an existing switch, join the feed from the switchboard to the load wire (going to lights). This will extend the feed wire to the ceiling.

Wall cavity install; If wiring is existing find the feed and load cables. Connect per wiring diagram below. If no wiring exists in the wall ceiling install is recommended.

STEP 3 Wiring Controller:

Connect the wires per wiring diagram as follows:

- Line Hot (usually brown or red) to terminal marked LIVE.
- Line Neutral (usually blue or black) to terminal NEUTRAL.
- Load Hot (usually brown or red) to terminal LOAD-L.
- Load Neutral (usually blue or black) to terminal LOAD-N.

In the dimmer version the NEUTRAL and LOAD-N terminals are not common connected.

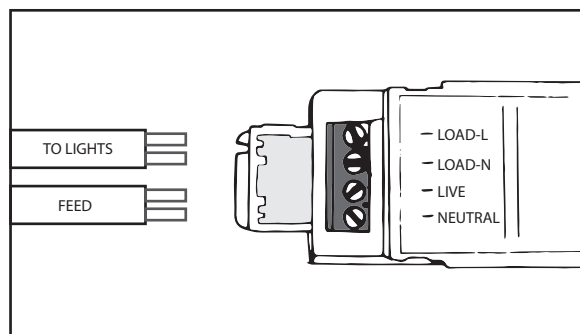

The connected lights should be wired in parallel with connection to the mains via the controller. Ensure the controller's maximum rating for a string of lights is not exceeded (500W ON/OFF; 150W Dimmable).

STEP 4 Check for loose wires and shorts:

The controller installation is complete.

STEP 5 Switch Module Installation:

The Switch Module communicates over radio frequency to the controller when the state of the mechanism is changed.

Insert battery into the battery clip with the + of the battery facing up. Use only 3 volt CR2032 type batteries. If existing remove existing wiring and light-switch from wall.

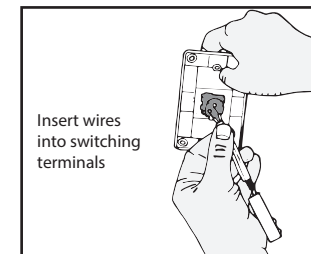
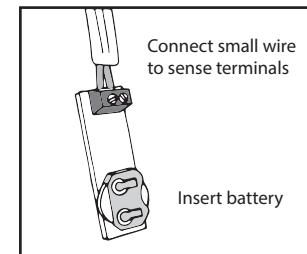

Connect switch module to switching terminals on the switch mechanism using a small wire.

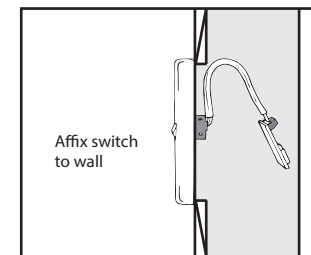

Affix the switch to the wall with the module inside the cavity.

DO NOT USE SWITCH MODULE WHERE MAINS VOLTAGE EXISTS. SWITCH MODULE OPERATES ON 3V BATTERY POWER ONLY.

STEP 6 Restore Power:

Restore power at circuit breaker. Test switch operation by flicking switch. Installation is complete.

TROUBLESHOOTING

Lights do not turn on; check:

- Circuit breaker has not tripped.
- Ensure wiring is correct (turn off power before checking).
- Check battery orientation and connection with bottom contactor, remove and re-insert.
- Ensure switch is within wireless range of the controller.

Lights flickering/flash; check:

- If dimmer controller is used check that lighting is dimmable.
- Bad wiring connection.